



# iMin Swan 1

Desktop POS



*Single Display*



*Dual Display*



*Detachable Secondary Display*



*Rotatable Secondary Display*



*Detachable Secondary Display for Signature*

\* Swan 1 Secondary Display comes with the option to support NFC and touchscreen.

## Two Secondary Screen Options



Normal Secondary Display



NFC on the Secondary Display

## Three Optional Accessories

### A1 – Detachable Stand

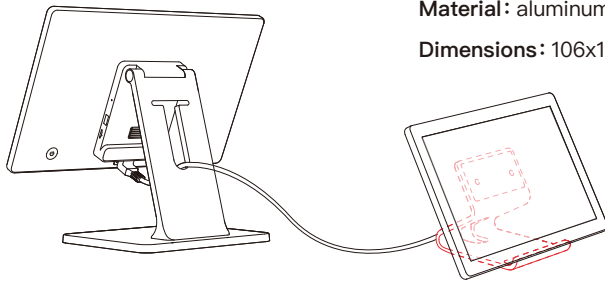

**Display Cable:** 100cm in length

**Material:** aluminum alloy

**Dimensions:** 106x111x96mm

### A2 – Rotatable Stand

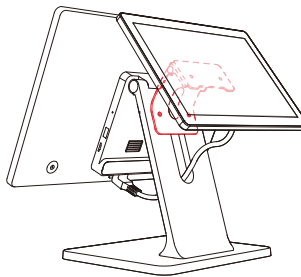

**Display Cable:** 30cm in length

**Rotation angle:** 0°~ 60°

**Material:** SPCC

**Dimensions:** 98x55.5x79mm

### A3 – Signature Stand

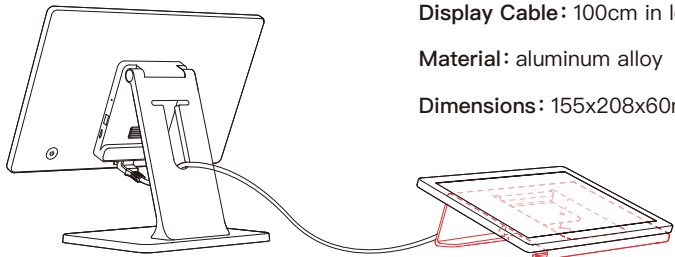

**Display Cable:** 100cm in length

**Material:** aluminum alloy

**Dimensions:** 155x208x60mm

\* The product pictures and display contents in the above pages are for illustration purposes only. The actual product effects (including but not limited to appearance, color, size) and screen display contents (including but not limited to background UI pictures) might differ.

The performance results are obtained from iMin's internal laboratory and extracted from specific test environments. In actual use, there might be a difference in performance due to individual differences in product, software, use conditions and environmental factors.

The secondary display and accessories (display cable extension) are sold separately according to user needs.