



Sink Specifications

Color	SKU
Satin Finished	525243

Design and Planning Tips

- Min cabinet size: 36 in
- Bowl depth: 9 in (229.0 mm)
- Apron front height: 10 in

What is included:
Installation instructions
Cut-out template
Limited Lifetime Warranty

Apron front installation only
Minimum cabinet size: 36"
Cut-out Dimensions: custom installation. Use sink as template
Sink Bowl Dimensions:
Sink Bowl Length (left-to-right): 31"
Sink Bowl Width (front-to-back): 15.75"
Sink Bowl Depth: 9"
Apron Front Depth: 9"
Drain hole compatible with 3.5" strainers or waste flanges
Codes/Standards: ASME A112.19.3-2017/CSA B45.4-17

Optional Accessories

Sink Grid	237516
QUATRUS ERGON Rails	235906
CapFlow Strainer Cover	517666

QUATRUS R15 ERGON Stainless steel Satin Finished

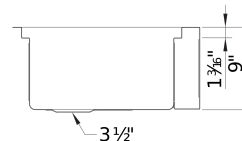
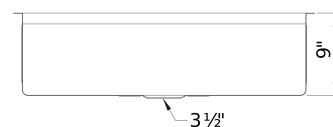
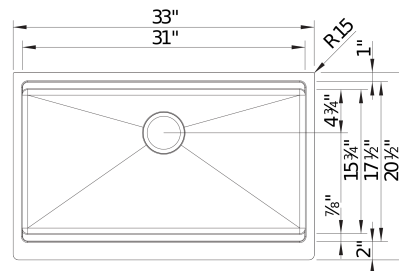

Warranty

BLANCO offers a limited lifetime warranty on all sinks and faucets, as well as a one-year warranty on all custom accessories.

Code/Standards Compliance

BLANCO sinks and faucets are third-party tested and certified to standards and listed by applicable certification bodies. For more information on individual product listings, contact our office or listing organization.



View our how-to videos to learn more about installing and caring for BLANCO products:
<https://www.blanco.com/us-en/service/how-to-videos/how-to-videos-for-sinks/>

Questions? Contact us today



BLANCO America, Inc.
110 Mount Holly By-Pass
Lumberton, NJ 08048

Phone & Fax
Phone: 888-668-6201
Fax: 609-668-6211

While BLANCO endeavors to provide accurate information, all dimensions are nominal, cannot be guaranteed, and are subject to change or cancellation. BLANCO assumes no responsibility for use of superseded or voided specifications.