

ProPEX lead-free (LF) brass residential ball valves

Project Information

Job name :	Location :
Engineer :	Date submitted:
Contractor :	Submitted by:
Manufacturer's representative :	Approved by :

Technical data

Material	LF Brass
Manifold size	inch
Temp/pressure ratings	200 °F (93 °C) at 200 psi (13.8 bar)
Prop 65 label required?	Yes

Product information and application use

To help meet the stringent demands of residential plumbing and hydronic distribution projects, Uponor is offering new ProPEX® ASTM F1960 lead-free (LF) brass ball valves in sizes from ½" to 1". The full-port ball valves feature a chrome-plated ball.

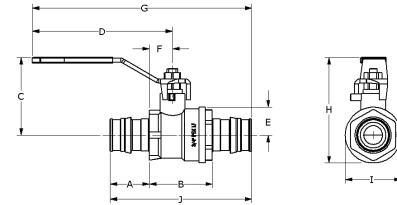

Part name	Part no.	A [inch]	B [inch]	C [inch]	D [inch]	E [inch]	F [inch]	G [inch]	H [inch]	I [inch]	J [inch]
ProPEX LF Brass Stop and Drain Ball Valve (full port), 1" PEX x 1" PEX:	LFD4811010:	1.181:	1.862:	1.978:	4.227:	0.746:	0.909:	6.361:	2.724:	2.022:	4.224:
ProPEX LF Brass Stop and Drain Ball Valve (full port), 1/2" PEX x 1/2" PEX:	LFD4815050:	0.709:	1.449:	2.867:	3.681:	1.624:	0.725:	5.114:	2.071:	1.437:	2.867:
ProPEX LF Brass Stop and Drain Ball Valve (full port), 3/4" PEX x 3/4" PEX:	LFD4817575:	0.945:	1.657:	1.841:	4.241:	0.602:	0.803:	6.04:	2.443:	1.726:	3.548:
ProPEX LF Brass Ball Valve (full port), 1" PEX x 1" PEX:	LFR4811010:	1.181:	1.618:	2.208:	4.503:	0.746:	0.685:	6.617:	2.954:	1.492:	3.98:
ProPEX LF Brass Ball Valve (full port), 1/2" PEX x 1/2" PEX:	LFR4815050:	0.709:	1.228:	1.647:	3.361:	0.447:	0.465:	4.834:	2.094:	0.939:	2.646:
ProPEX LF Brass Ball Valve (full port), 3/4" PEX x 3/4" PEX:	LFR4817575:	0.945:	1.357:	1.796:	3.361:	0.634:	0.522:	5.142:	2.43:	1.268:	3.247:

Part name	Part no.	Cv	Cv Through	Weight per UOM [lbs/UOM]	End Type 1	End Type 2
ProPEX LF Brass Stop and Drain Ball Valve (full port), 1" PEX x 1" PEX:	LFD4811010:	31.7:	-:	0.9:	ProPEX 1" :	ProPEX 1" :
ProPEX LF Brass Stop and Drain Ball Valve (full port), 1/2" PEX x 1/2" PEX:	LFD4815050:	6.5:	-:	0.35:	ProPEX 1/2" :	ProPEX 1/2" :
ProPEX LF Brass Stop and Drain Ball Valve (full port), 3/4" PEX x 3/4" PEX:	LFD4817575:	16.6:	-:	0.6:	ProPEX 3/4" :	ProPEX 3/4" :
ProPEX LF Brass Ball Valve (full port), 1" PEX x 1" PEX:	LFR4811010:	31.4:	-:	0.88:	ProPEX 1" :	ProPEX 1" :
ProPEX LF Brass Ball Valve (full port), 1/2" PEX x 1/2" PEX:	LFR4815050:	6.7:	-:	0.34:	ProPEX 1/2" :	ProPEX 1/2" :
ProPEX LF Brass Ball Valve (full port), 3/4" PEX x 3/4" PEX:	LFR4817575:	15.8:	-:	0.5:	ProPEX 3/4" :	ProPEX 3/4" :

Installation

Install valve and stem extension kit according to local building code. Do not dismantle. Refer to the Uponor Piping Pocket Guide or the Uponor Plumbing Design Assistance Manual (PDAM) for additional information.

Related applications

- Hot water distribution
- Hydronic heating and cooling systems
- Hydronic Piping Systems
- Hydronic Radiant Heating and Cooling Systems
- PEX-a Plumbing Systems
- Plumbing Systems
- Pre-Insulated Pipe Systems
- Radiant Heating and Cooling Systems

Codes	Standards	Listings
UPC IBC IRC IPC NPC of Canada UMC IMC:	NSF-372 ASTM F877 NSF-359 ASTM F1960 CSA B137.5 NSF-61 NSF-14:	cNSFus-pw-G U.P.Code:

Footnotes	Contact information	
-	Uponor Inc. 5925 148th Street West Apple Valley, MN 55124 T 800.321.4739 F 952.891.2008	Uponor Ltd. 6510 Kennedy Road Mississauga, ON L5T 2X4 T 888.594.7726 F 800.638.9517