

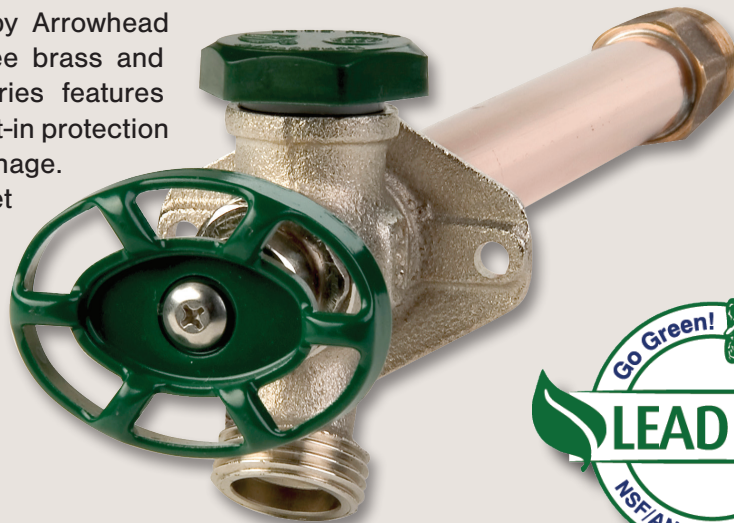

420 Series Lead Free Anti-Siphon Frost-Proof Wall Hydrants

Anti-Siphon Frost-Proof Wall Hydrants by Arrowhead Brass are made of heavy-duty Lead-Free brass and copper. The Arrowhead Brass 420 series features QuickTurn® easy on-off operation and built-in protection from back-pressure and back-flow siphonage. Available in various lengths and inlet connections, Arrowhead Brass frost-proof wall hydrants are perfect for any installation to provide outdoor watering all year. Arrow-Breaker Frost-Proof Wall Hydrants are UPC listed and certified to ASSE 1019-A and NSF/ANSI 372 Lead-Free by IAPMO.



Features and Specifications

- Heavy duty lead free brass and copper construction. NSF/ANSI 372 certified Lead Free by IAPMO.
- Utilizes Arrowhead's exclusive no-leak one-piece bonnet with EPDM O-ring seal and QuickTurn® easy on-off operation.
- Integral anti-siphon protects your household water supply from harmful contaminants.
- Nickel plated, solid brass body and wall flange with built-in offset to allow water drainage upon shut-off.
- Maximum pressure: 125 PSI. Max temperature: 140° F
- Flow rate: 14 GPM at 50 PSI.
- 3-year limited warranty.
- Rubber-coated oval handle, or available in loose-key lock-shield (LKLF) models for tamper-proof operation.
- **Per ASSE 1019 plumbing code, this product is not intended to be under constant pressure (turned on) for over 12 hours at a time. Use of Y-Splitters or hose-bib sprinkler timers is not suggested.**

Models

421-**-QTLF	3/4" Cold Expansion PEX (ASTM F1960)	
422-**-QTLF	1/2" Cold Expansion PEX (ASTM F1960)	
425-**-QTLF	1/2" Female Pipe Thread ID. 3/4" Male Pipe Thread OD.	
426-**-QTLF	1/2" Copper Sweat ID. 1/2" Male Pipe Thread OD.	
427-**-QTLF	3/4" Crimp PEX (ASTM F1807)	
428-**-QTLF	3/4" Copper Sweat ID. 3/4" Male Pipe Thread OD.	
429-**-QTLF	1/2" Crimp PEX (ASTM F1807)	

**** = Hydrant length:**

- 02 - 2" insertion depth
- 04 - 4" insertion depth
- 06 - 6" insertion depth
- 08 - 8" insertion depth
- 10 - 10" insertion depth
- 12 - 12" insertion depth
- 14 - 14" insertion depth

Longer lengths available by special order

Prevent unwanted water use with Loose Key Models: "LKLF" Suffix

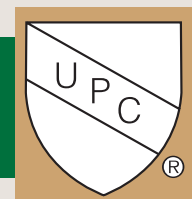
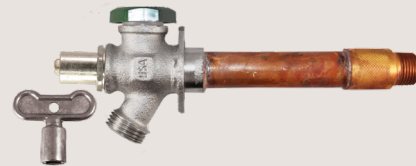



420 Series Lead Free Anti-Siphon Frost-Proof Wall Hydrants

Dimensions

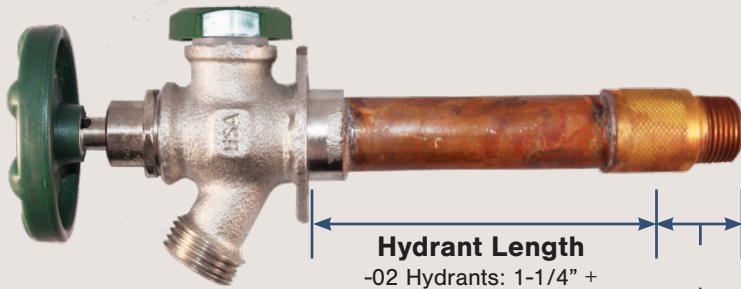

Hydrant Length

- 02 Hydrants: 1-1/4" +
- 04 Hydrants: 4" +
- 06 Hydrants: 6" +
- 08 Hydrants: 8" +
- 10 Hydrants: 10" +
- 12 Hydrants: 12" +
- 14 Hydrants: 14" +

Inlet #	Connection Type	Add. Length
1	3/4" Cold Expansion PEX (ASTM F1960)	2"
2	1/2" Cold Expansion PEX (ASTM F1960)	1-3/4"
5	1/2" Female Pipe Thread ID. 3/4" Male Pipe Thread OD.	1-5/8"
6	1/2" Copper Sweat ID. 1/2" Male Pipe Thread OD.	1-1/2"
7	3/4" Crimp PEX (ASTM F1807)	1-5/8"
8	3/4" Copper Sweat ID. 3/4" Male Pipe Thread OD.	1-5/8"
9	1/2" Crimp PEX (ASTM F1807)	1-5/8"

Part Kits

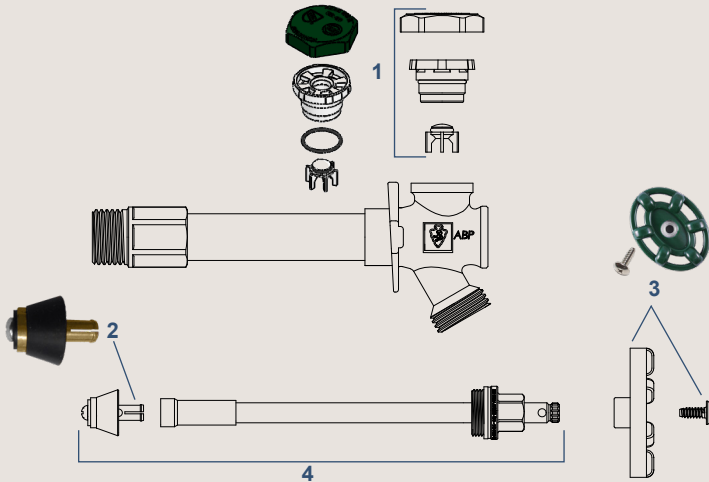

ID	Part #	Description
1	PK1430	Replacement Anti-Siphon Air Vent Assembly
2	PK2016	Replacement Anti-Siphon Check Assembly
3	PK1295	Rubber-Coated Oval Handle (Die-cast Aluminum) and Stainless Steel Self-Tapping Handle Screw
4	(See below)	Replacement Anti-Siphon Stem Assembly (includes PK2016)

Replacement Stem Assemblies



Total Stem Length (Overall)
with check assembly compressed

Part #	Description	Length
PK2002	Stem assembly for 2" 420 series hydrant	6" total
PK2004	Stem assembly for 4" 420 series hydrant	8" total
PK2006	Stem assembly for 6" 420 series hydrant	10" total
PK2008	Stem assembly for 8" 420 series hydrant	12" total
PK2010	Stem assembly for 10" 420 series hydrant	14" total
PK2012	Stem assembly for 12" 420 series hydrant	16" total
PK2014	Stem assembly for 14" 420 series hydrant	18" total

Old Design



New & Improved Design



*The 420 series was redesigned in June of 2020. The new design will retrofit into existing frost-proof hydrants and the new design can be visually identified by the larger collar present on the stem housing.

Please contact a Champion-Arrowhead sales representative for additional information.

Warning: Frost-Proof Wall Hydrants must be installed with a downward tilt toward hose thread outlet AND the hose or other devices must be removed in cold and freezing weather. Failure to properly winterize a frost-proof wall hydrant can result in damage caused by freezing water and is not covered by under warranty.