

Kwikset

663 ONE-SIDED DEADBOLT



Kwikset's 663 Deadbolt offers effective security at an affordable price.

- Easy to Install
- Features Microban® antimicrobial finish protection*
- ANSI/BHMA Grade 3 Certified Security & Quality

*Microban® available in the following finishes:
Polished Brass (3), Antique Brass (5), Satin Nickel (15), Venetian Bronze (11p),
and Matte Black (514)

#1 SELLING U.S. LOCK BRAND*

*Source: TraQline US quarterly brand unit share report, Q4 2006 through Q1 2021

Specifications

Door Prep	Cross Bore 2-1/8". Edge Bore 1". Latch face 1" x 2 1/4".
Backset	2 3/8" or 2 3/4" standard.
Door Thickness	1 3/8" - 1 3/4" doors standard.
Faceplates	1" x 2 1/4". Specify round corner, square corner or drive-in.
Strikes	1" x 2 1/4" full. Specify round corner or square corner. Other options available.
Bolt	1" throw.
Door Handing	Reversible for right or left-hand doors.
ANSI/BHMA	A156.2 Grade 3
ADA	Interior turn piece meets 413.9 ADA requirements.
UL	N/A

Functions



663 Thumb Turn Only:

Deadbolt operated by thumb turn one side.
No trim on exterior.



SMARTKEY SECURITY™

Kwikset's SmartKey Security™ provides homeowners with the superior security that is resistant to a variety of advanced break-in methods.

This technology also allows homeowners to re-key their locks themselves in seconds, rendering lost or un-returned keys useless.

Dimensions

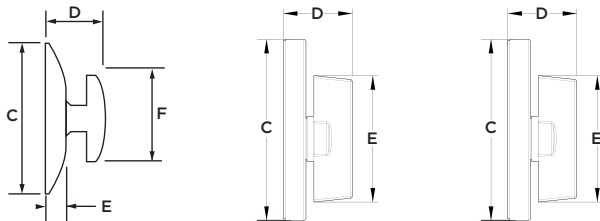

Design	A	B	C	D	E	F
663			2 1/2"	27/32"	5/16"	1 3/4"
663 CRR			2 1/2"	3 1/32"	1 3/4"	
663 SQT			2 1/2"	3 1/32"	1 3/4"	

LIFETIME WARRANTY

Finishes

MICROBAN®



Polished
Brass **LO3/3**

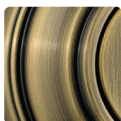

Antique
Brass **5**



Venetian
Bronze **11P**



Satin
Nickel **15**



Matte
Black **514**



Antique
Nickel **15A**



Polished
Chrome **26**



Satin
Chrome **26D**

* 663 available in 3, 5, 11P, 15, 15A, 26 and 26D

663 CRR available in 5, 11P, 26 and 26D

663 SQT available in 11P, 15, 26 and 514