



# 1L Round Fluorinated or Conventional

25/11/09

Available Weights: 60 ±3g  
80 ±3g

Brimful Capacity : 1130 ±20ml  
1100 ±20ml

Material: HDPE

All dimensions are in mm

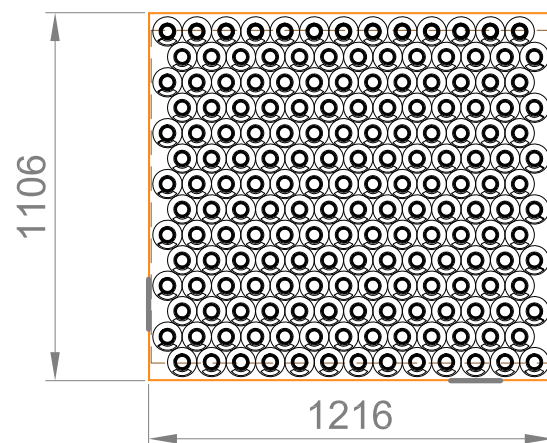
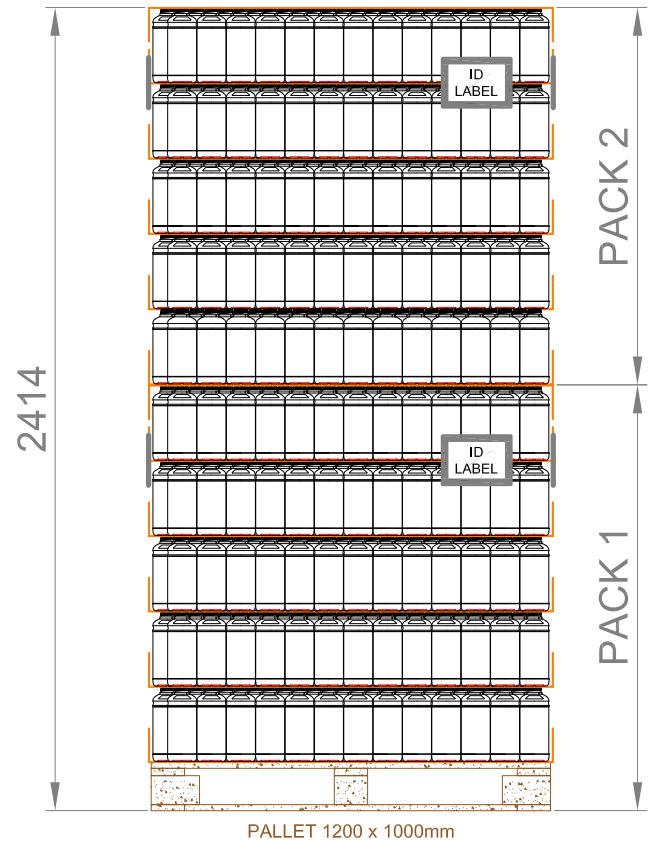
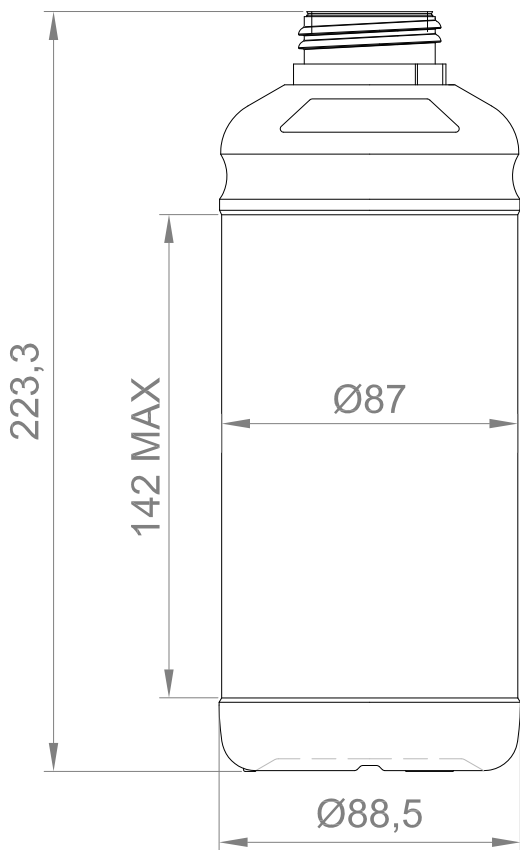
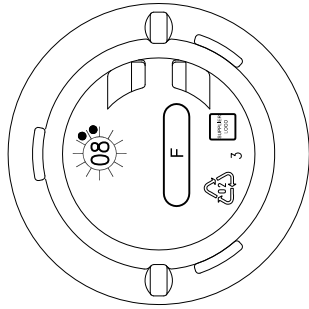

Base Markings: *Cavity number, Date, "F" when Fluorinated, "C" when Conventional*

Cap Options : *42mm with Tamper Evident*

Wad Options: *PET / ALU / EPE, IHS or Tresylene*

UN Certification: *For Combined or Freestanding following the density of your products, please contact us*

Gross Weight Approx: *Including Pallet, 124Kg for 60g bottle & 156Kg for 80g bottle*

Quantity / Pallet: *1820*

Quantity / Lorry: *40040 (22 Pallets) bottles only, 38220 (21 Pallets) with caps*